

to

REPORT PLAN2018-013

FILE NO: D06-2018-006

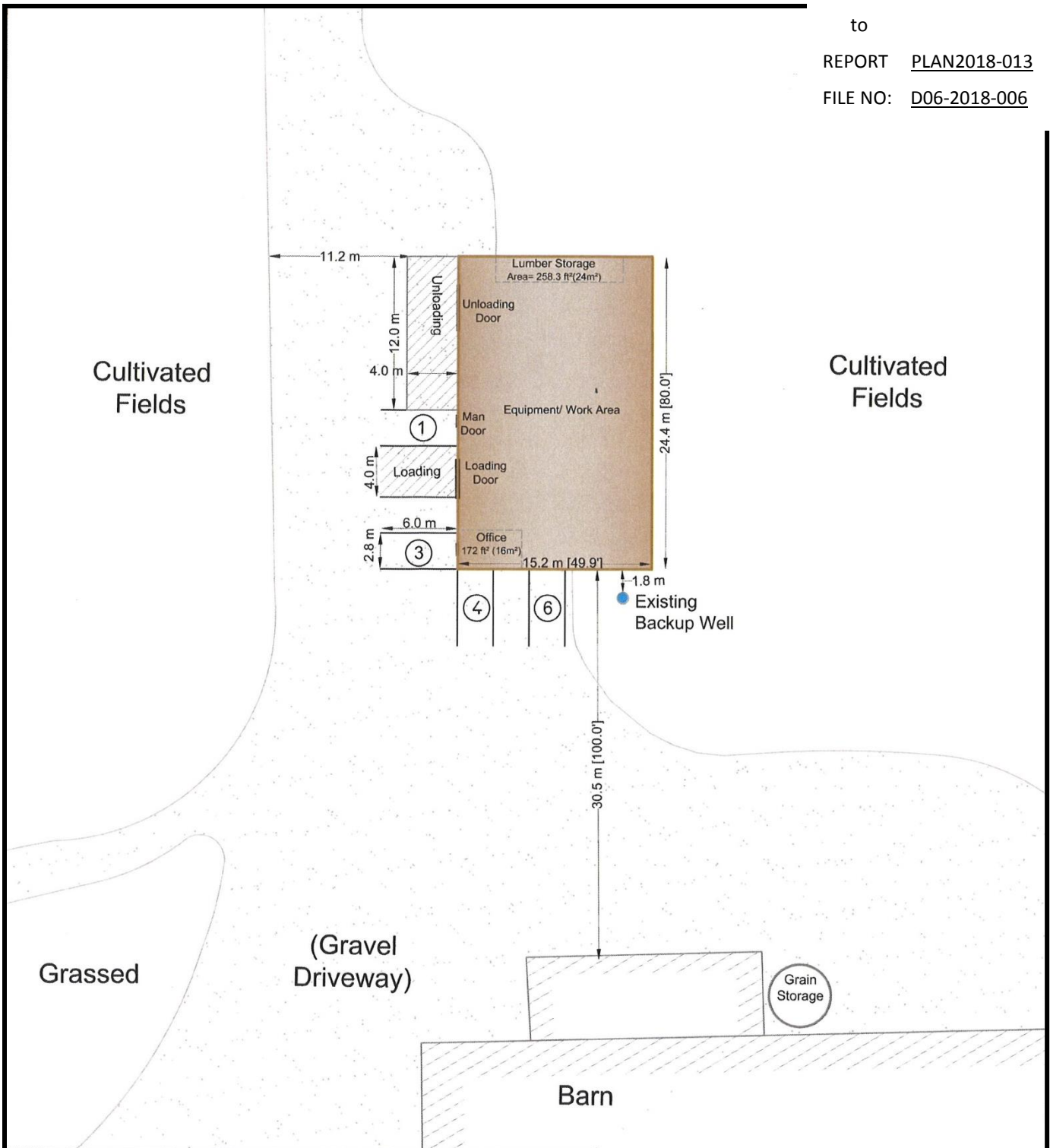

Woodworking Shop

- Building Floor Area 4000 ft² (371.6m²)
- Single Storey

## PROPOSED WOODWORKING SHOP DEVELOPMENT CONCEPT SKETCH

NELSON GINGRICH

432 KINGS WHARF ROAD

PART LOT 7, AND ALL OF LOT 8 CONCESSION 14 - EMILY  
CITY OF KAWARTHA LAKES

Scale: 1 : 500 metres



October, 2017

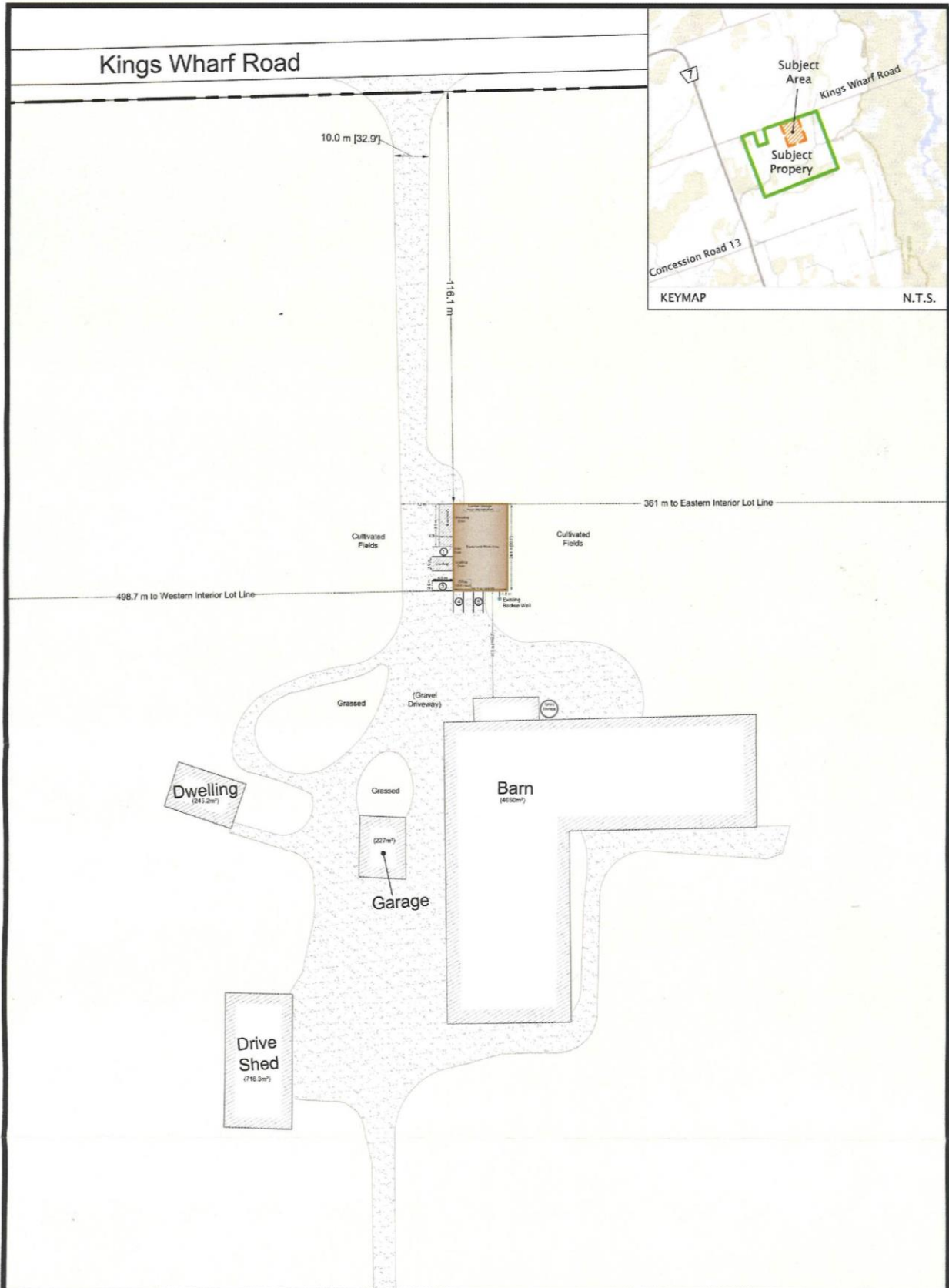

Woodworking Shop

- Building Floor Area 4000 ft² (371.6m²)
- Single Storey

## PROPOSED WOODWORKING SHOP CONECPTUAL SITE PLAN LAYOUT

NELSON GINGRICH

432 KINGS WHARF ROAD

PART LOT 7, AND ALL OF LOT 8 CONCESSION 14 - EMILY  
CITY OF KAWARTHA LAKES

Scale: 1 : 1000 metres



October, 2017

