

to

REPORT PLAN2018-032

FILE NO: D06-2018-006

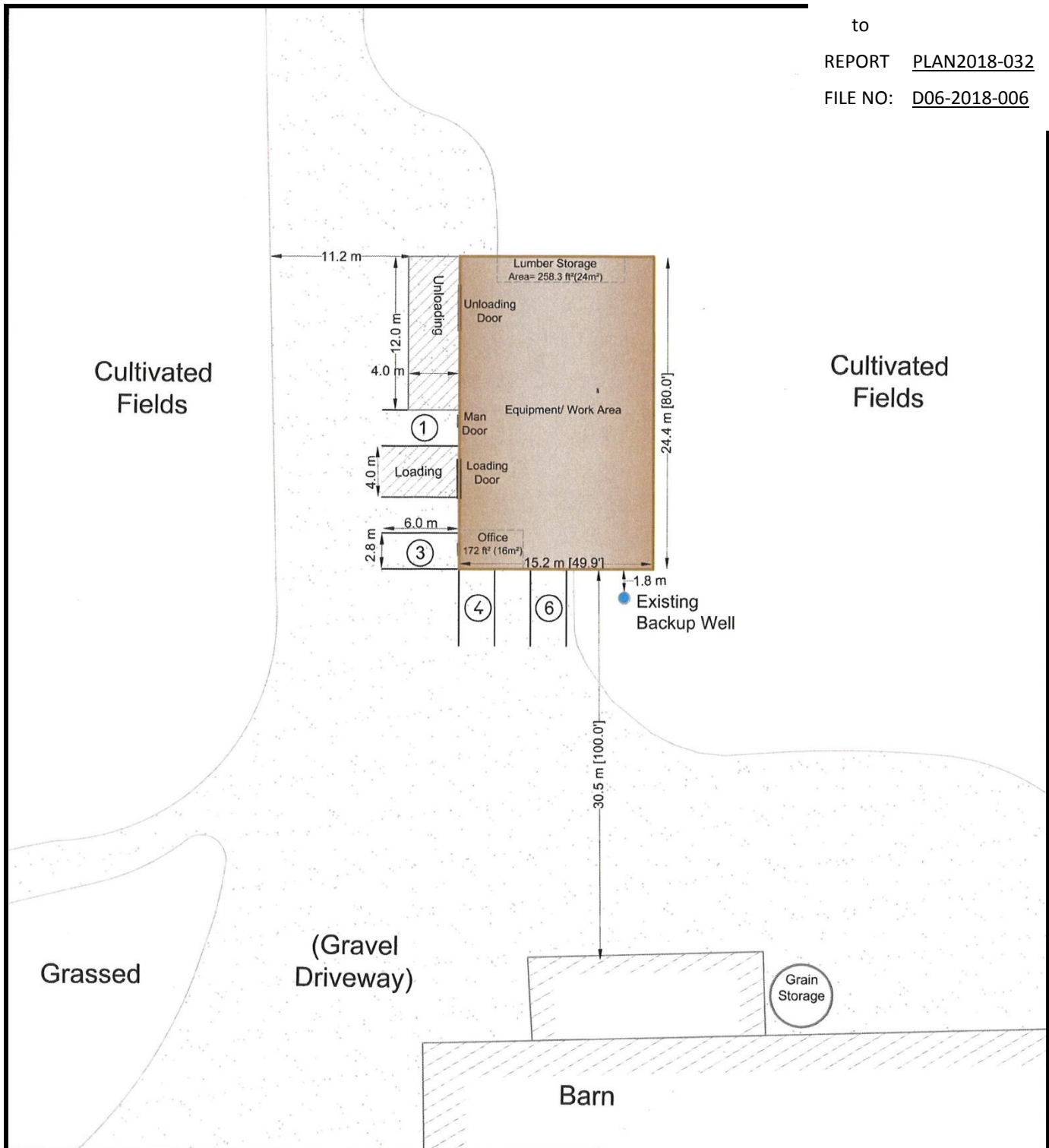

**Woodworking Shop**  
 - Building Floor Area 4000 ft² (371.6m²)  
 - Single Storey

**PROPOSED WOODWORKING SHOP  
 DEVELOPMENT CONECPY SKETCH**

Scale: 1 : 500 metres

**NELSON GINGRICH**  
 432 KINGS WHARF ROAD  
 PART LOT 7, AND ALL OF LOT 8 CONCESSION 14 - EMILY  
 CITY OF KAWARTHA LAKES



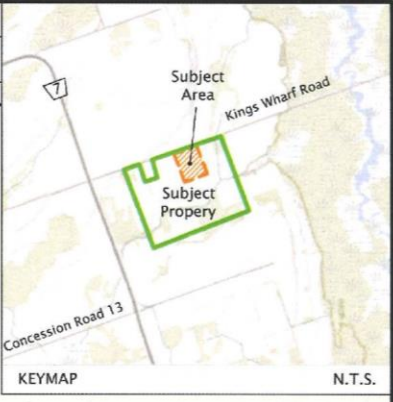
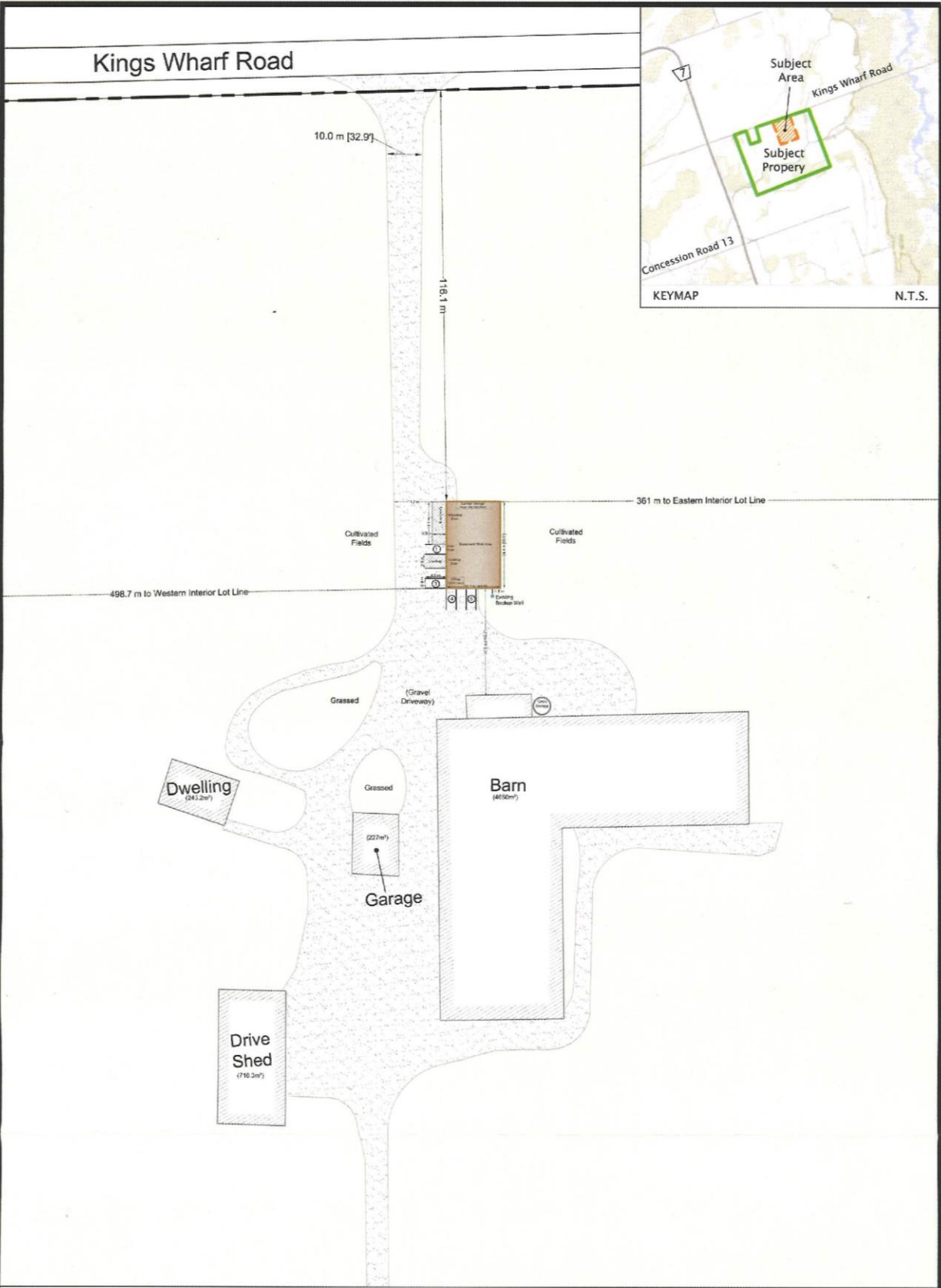

- Woodworking Shop
- Building Floor Area 4000 ft<sup>2</sup> (371.6m<sup>2</sup>)
- Single Storey

**PROPOSED WOODWORKING SHOP  
CONECPTUAL SITE PLAN LAYOUT**

**NELSON GINGRICH**  
432 KINGS WHARF ROAD  
PART LOT 7, AND ALL OF LOT 8 CONCESSION 14 - EMILY  
CITY OF KAWARTHA LAKES

Scale: 1 : 1000 metres



