

APPENDIX " B "

to
REPORT PLAN2019-002

FILE NO. D06-2018-025

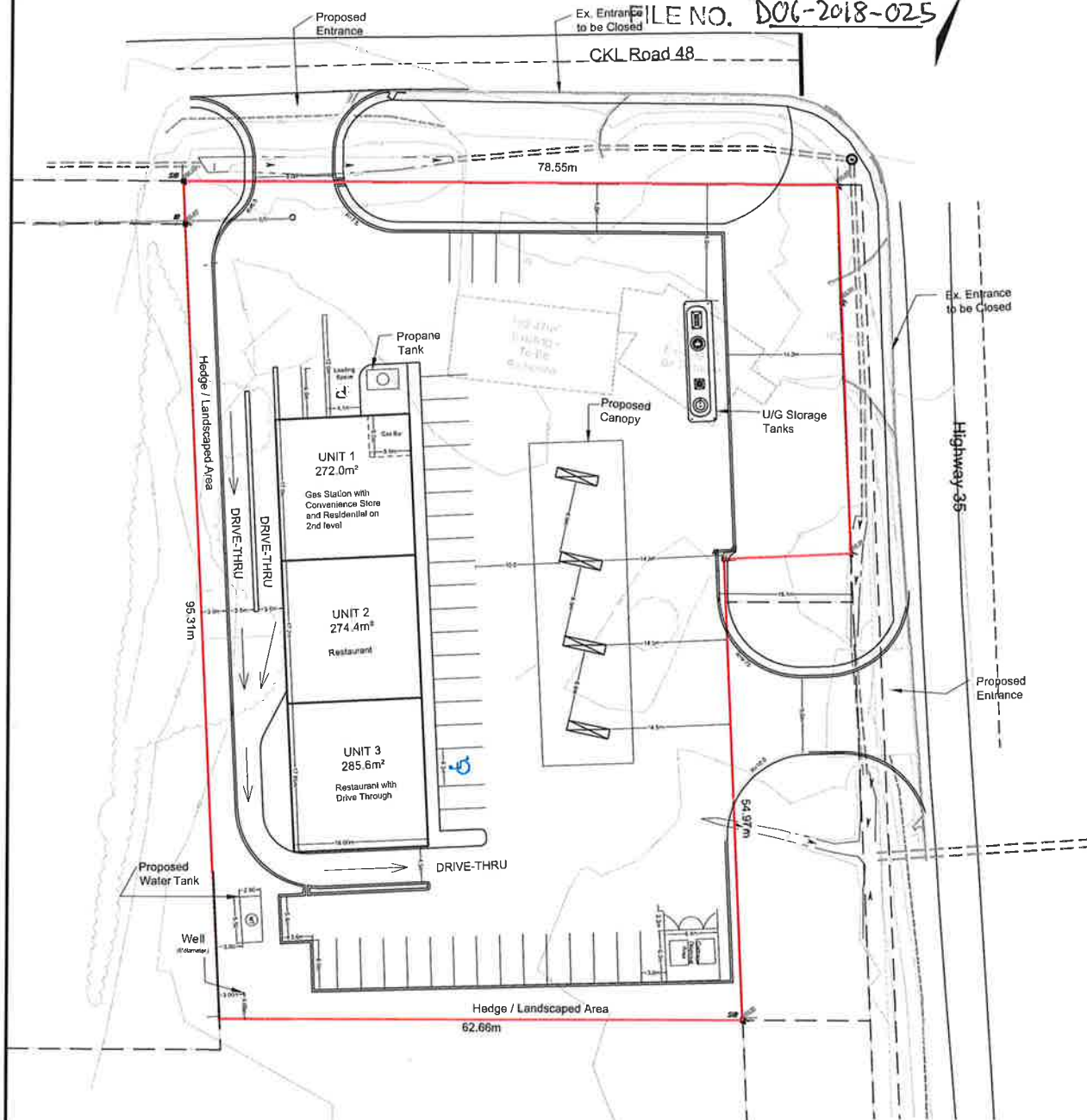

RECEIVED

JUN 22 2018

City of Kawartha Lakes
Development Services
Planning Division

LEGEND

- Subject Property
- Proposed Building Footprint
- Proposed Parking 2.8x6m (39)
- *Accessible Parking 3.5x6m (1)
- Gas Pump Island (4)
- Ex. Watercourse
- Ex. Wooded Area
- Loading Space 12x4.1m (1)



PROJECT NO: 17-1689
DATE: June 5 2018
HORIZ. SCALE: 1:500

Concept Plan Gas Station

Part of Lot 18, Gull River Range (Bexley)
City of Kawartha Lakes - 2926 County Road 48