

SKETCH
LICENSE AGREEMENT

TOWN OF LINDSAY
NOW IN THE
CITY OF KAWARTHA LAKES

Scale 1 : 300

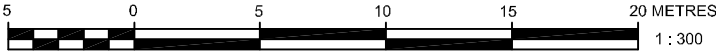

METRIC:
DISTANCES SHOWN ON THIS PLAN ARE IN METRES AND CAN BE
CONVERTED TO FEET BY DIVIDING BY 0.3048.

SCHEDULE "A"

STREET

ANGELINE



ELGIN PARK

©

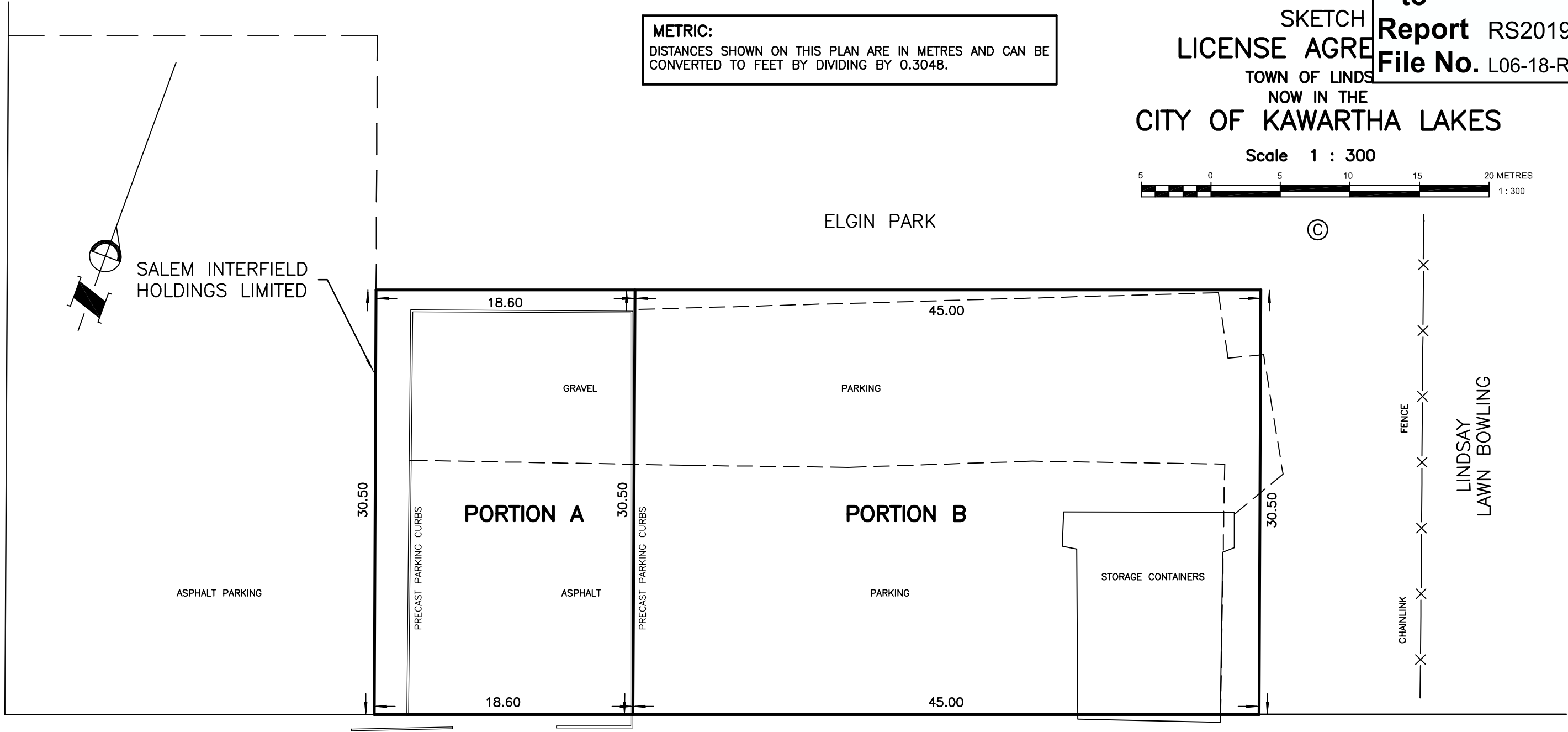
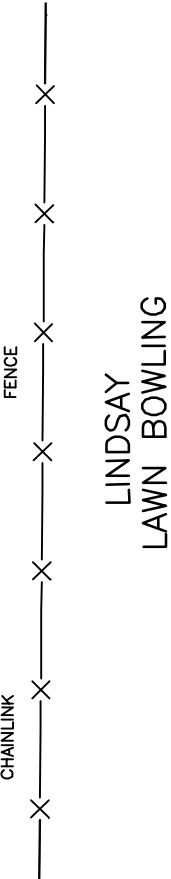

AREAS

PORTION A
567.3 SQ.M.

PORTION B
1372.5 SQ.M.

ELGIN STREET

DATE: JULY 17, 2013



COE, FISHER, CAMERON
ONTARIO LAND SURVEYORS
LINDSAY, ONTARIO - PHONE 324-4152

DWN. BY: C.R.M.

CK'D.BY: G.G.H.

O-12-10791