

EMPLOYEE PARKING - 82 + 94 HEAD ST.
SCALE 1:300

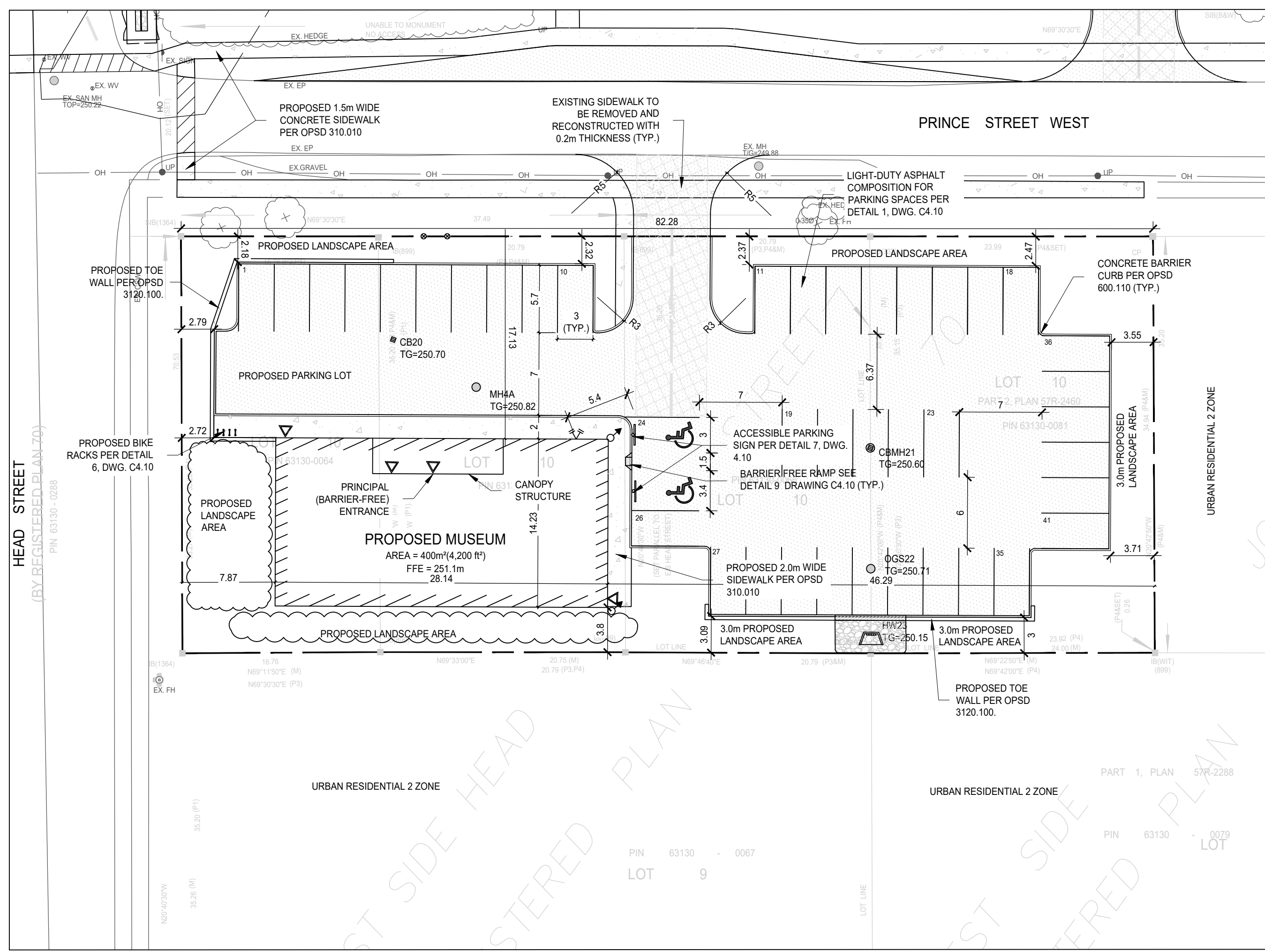

MUSEUM + VISITOR PARKING - 96, 100 + 102 PRINCE ST.
SCALE 1:300

SITE STATISTICS TABLE - MUSEUM & TOURIST PARKING LOT				
ADDRESS	96 + 100 + 102 PRINCE STREET, BOBCAYGEON, ON, CA			
ZONING	COMMERCIAL ZONE C1			
REGULATIONS	REQUIRED	EXISTING	PROPOSED	CONFORMS
LOT AREA (m ²)	N/A	±2,051	±2,051	Y
BUILDING AREA (m ²)	1,230.6 MAX	±205.1	400.0	Y
GROSS FLOOR AREA (m ²)	N/A	N/A	1,200	Y
LOT FRONTAGE (m)	N/A	82.28	82.28	Y
LOT COVERAGE	60% MAX	±10%	±19.5%	Y
BUILDING MAX. HEIGHT (m)	11.0m	N/A	10.96m	Y
NUMBER OF STOREYS	N/A	N/A	2	Y
SETBACK (m)				
FRONT YARD	N/A	N/A	17.13	Y
SIDE YARD WHEN ABUTTING RESIDENTIAL	1.2	N/A	7.87 EXT. SIDE 46.29 INT. SIDE	Y
REAR YARD	N/A	N/A	3.8	Y
PARKING				
1 PER 65 SQ.M (1,200m ²) OF FLOOR AREA, MINIMUM 5	19	N/A	41	Y
PARKING SPACE DIMENSION (m) WIDTH TO BE A MINIMUM OF 2.5m WITH A TOTAL AREA NOT LESS THAN 17.0m ²	WIDTH=3.0m X LENGTH=5.7m AREA=17.1m ²	-	3.0 X 5.7	Y
ACCESSIBLE PARKING SPACES	19*3%=1	-	2	Y

SITE STATISTICS TABLE - EMPLOYEE PARKING LOT				
ADDRESS	94 + 82 HEAD STREET, BOBCAYGEON, ON, CA			
ZONING	COMMERCIAL ZONE C1			
REGULATIONS	REQUIRED	EXISTING	PROPOSED	CONFORMS
LOT AREA (m ²)	N/A	N/A	66	Y
PARKING SPACES (THE FIRST 280m ² OF THE PREMISES, 1 PER 45m ² OF FLOOR AREA OR PORTION THEREOF AND FOR ANY ADDITIONAL FLOOR AREA, 1 PER 100m ² FOR FLOOR AREA OR PORTION THEREOF)	N/A	N/A	66	Y
PARKING SPACE DIMENSION (m) WIDTH TO BE A MINIMUM OF 2.5m WITH A TOTAL AREA NOT LESS THAN 17.0m ²	WIDTH=3.0m X LENGTH=5.7m AREA=17.1m ²	-	3.0 X 5.7	Y

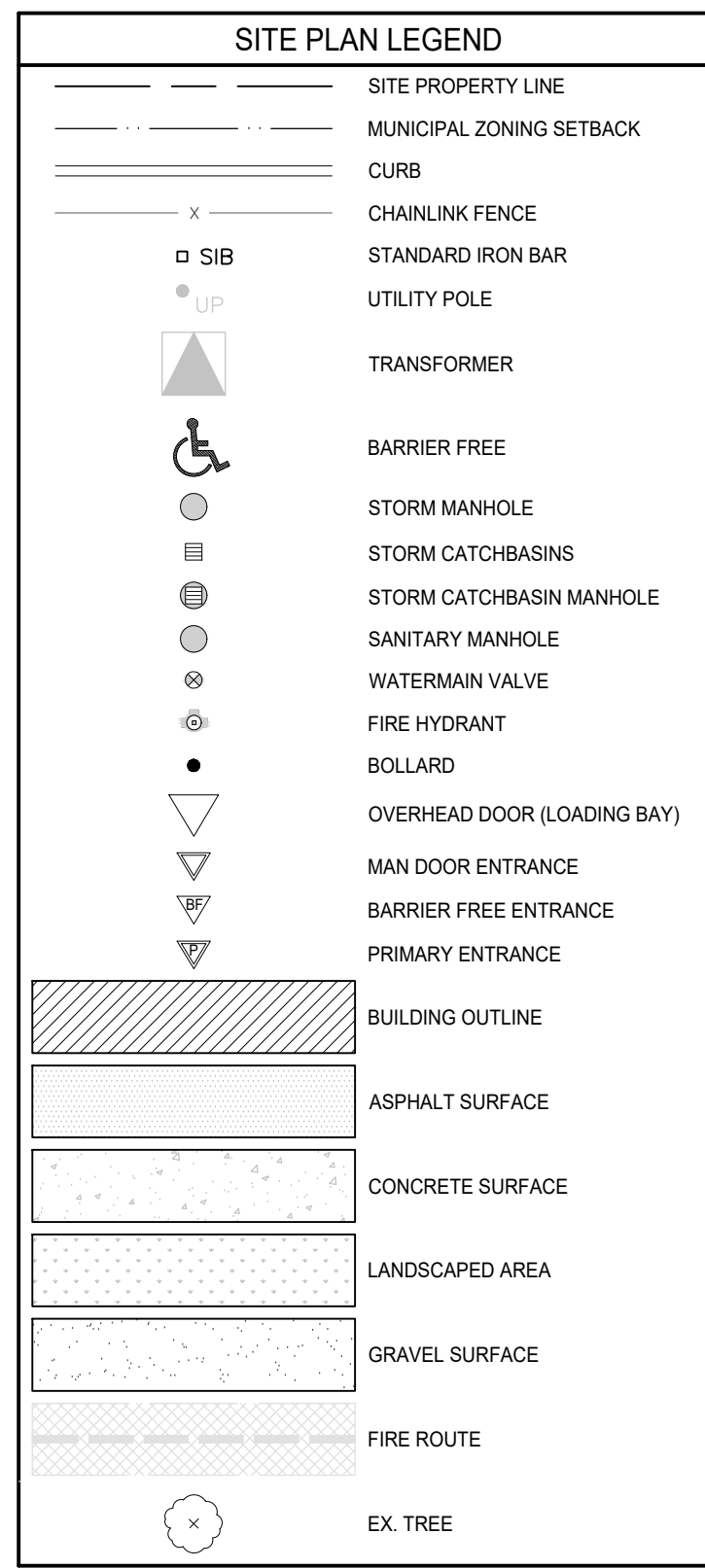

DRAWINGS SHALL NOT BE USED FOR CONSTRUCTION UNLESS SEALED BY A PROFESSIONAL ENGINEER. CONTRACTOR SHALL CHECK ALL DIMENSIONS ON DRAWINGS BEFORE PROCEEDING WITH THE WORK. ALL WORK TO BE PERFORMED IN ACCORDANCE WITH THE LATEST EDITION OF THE HEALTH AND SAFETY ACT.

No.	DATE	REVISION	BY
1	2023.06.16	ISSUED FOR OWNER REVIEW	AT
2	2023.11.03	ISSUED FOR ZONING BY-LAW AMENDMENT	AT
X	X	X	X
X	X	X	X

LEGAL INFORMATION
 LOTS 11 AND 12, WEST SIDE OF HEAD STREET AND LOTS 11 AND 12 AND EAST SIDE OF HEAD STREET AND LOTS 11, 12, AND 13 WEST SIDE OF JOHN STREET AND PART OF JOHN STREET (CLOSED BY BY-LAW 18-91, INSTRUMENT R283430) AND LOT 11 AND PART OF LOT 14 WEST SIDE OF JOSEPH STREET.
 REGISTERED PLAN 70 IN THE TOWN OF BOBCAYGEON COUNTY OF KAWARTHA LAKES

BENCHMARK:
 MONUMENT SITE: TYPE BENCHMARK
 LOCATION: TOP OF NUT ON HYDRANT AT SOUTH EAST CORNER OF SUBJECT SITE AT INTERSECTION OF JOSEPH STREET AND PRINCE STREET WEST.
 GEODETIC ELEVATION: 250.54

- DRAWING REFERENCES:**
1. TOPOGRAPHICAL INFORMATION SHOWN ON THIS PLAN WAS COLLECTED BY IBW SURVEYORS, DATED NOVEMBER 25, 2021
 2. ALL BOUNDARY INFORMATION SHOWN ON THIS PLAN WAS TAKEN FROM A PLAN PREPARED BY IBW SURVEYORS, PLAN NO. A-027890-POS_V2, DATED NOVEMBER 19, 2021
 3. FLOODLINE AND WATERCOURSE INFORMATION TAKEN FROM REPORT PREPARED BY SANCHEZ ENGINEERING LTD. DATED JUNE 8, 2016
 4. GEOTECHNICAL INFORMATION SHOWN ON THIS PLAN WAS TAKEN FROM A REPORT PREPARED BY CAMBIUM, DATED AUGUST 23, 2021
 5. INFORMATION RELATED TO THE EXISTING SERVICES ON HEAD STREET, JOSEPH STREET AND PRINCE STREET WAS TAKEN FROM PLANS PREPARED BY MALLOT CREEK GROUP, DATED JUNE 1981
 6. ARCHITECTURAL INFORMATION SHOWN ON THIS PLAN WAS TAKEN FROM PLANS PREPARED BY MALLOT CREEK GROUP, DATED JUNE 1981
 7. INFORMATION RELATED TO EXISTING WETLAND AND ASSOCIATED BUFFER TAKEN FROM AN EIS REPORT PREPARED BY D.M. WILLS, DATED JUNE 2021

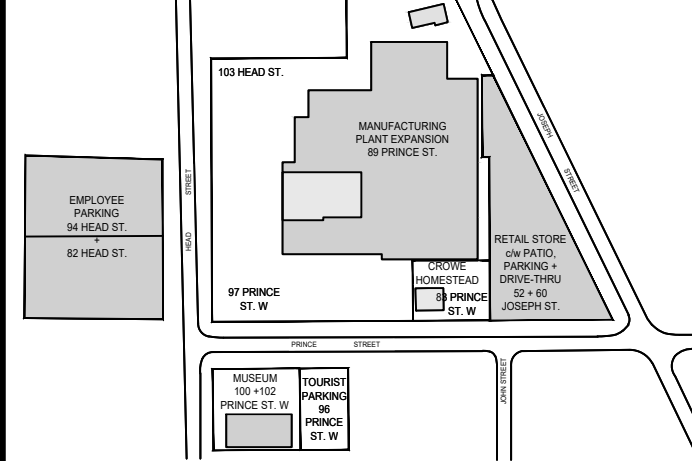

KEY PLAN
N.T.S.

Mallot Creek Group Inc.
 284 Mill Street East, Suite 201
 Elora, ON N0B 1S0
 T: 519-646-1830
 F: 519-646-1833
 info@mallotcreek.com
 www.mallotcreek.com

Kawartha Dairy
 KAWARTHA DAIRY
 89 PRINCE ST. W
 BOBCAYGEON, ON, CANADA

PROJECT DEMETER

SITE PLAN - MUSEUM AND EMPLOYEE PARKING LOT

	DESIGN BY:	AT
	DRAWN BY:	DB
	CHECKED BY:	AT
	DATE:	2023.06.16
	SCALE:	1:300
PROJECT NUMBER:		21010

SEE NOTES ON SHEET C0.10